

Access Control Case DHI-VTM501 Internal Wiring Guide

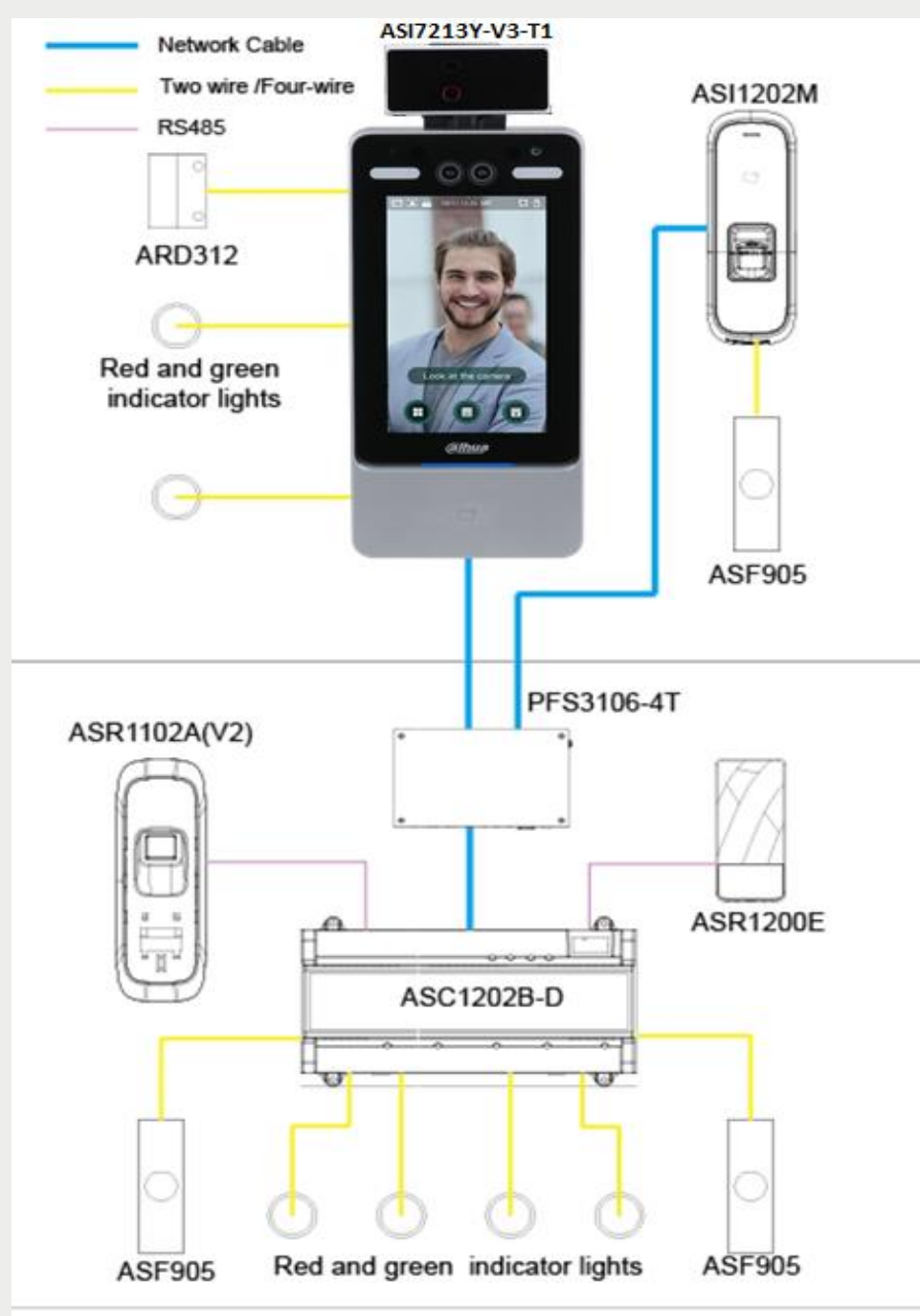

Schematic Diagram

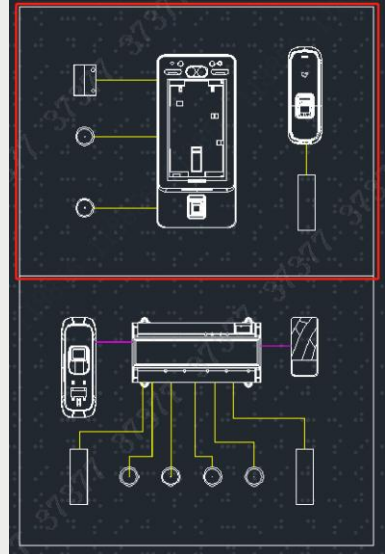

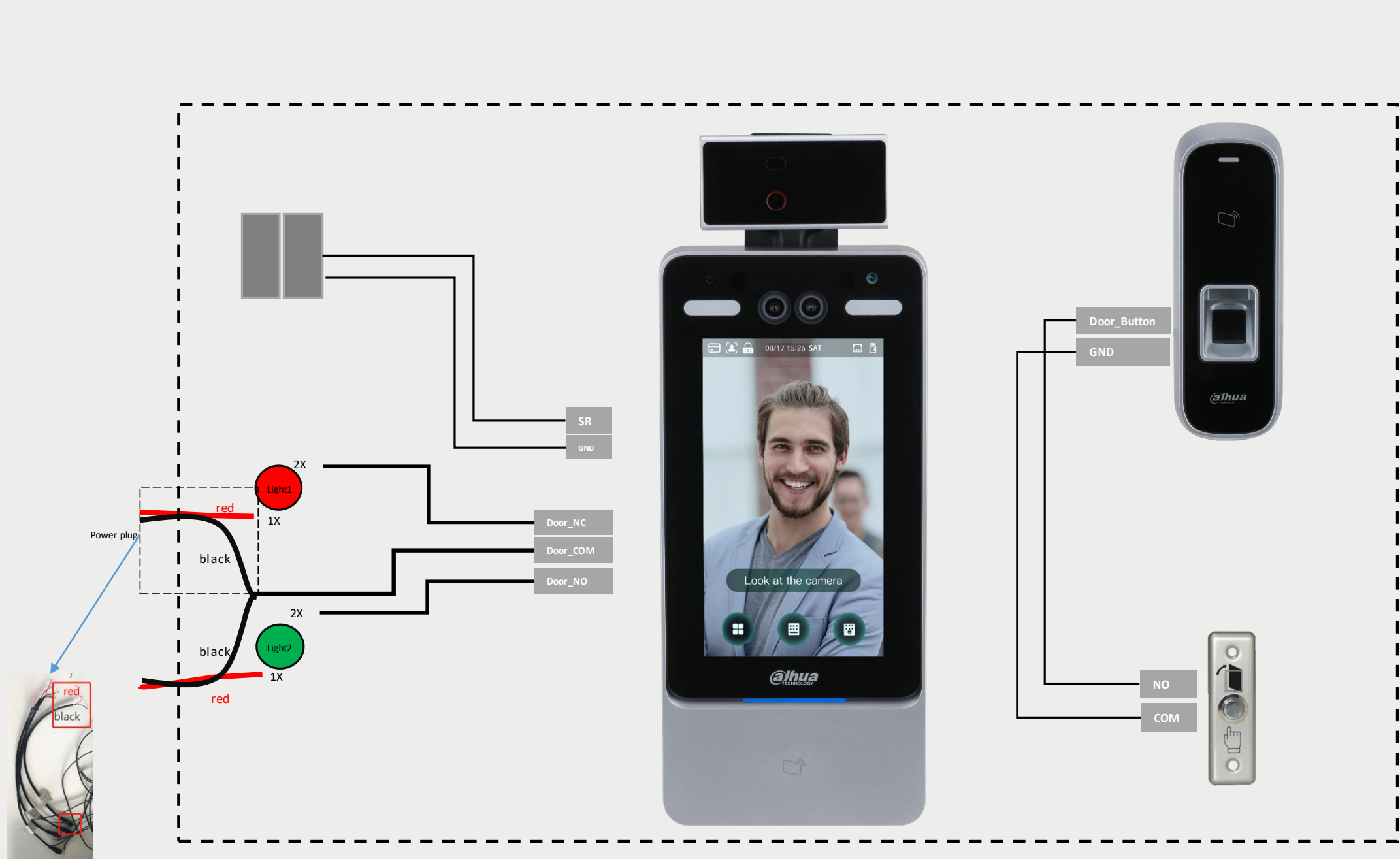

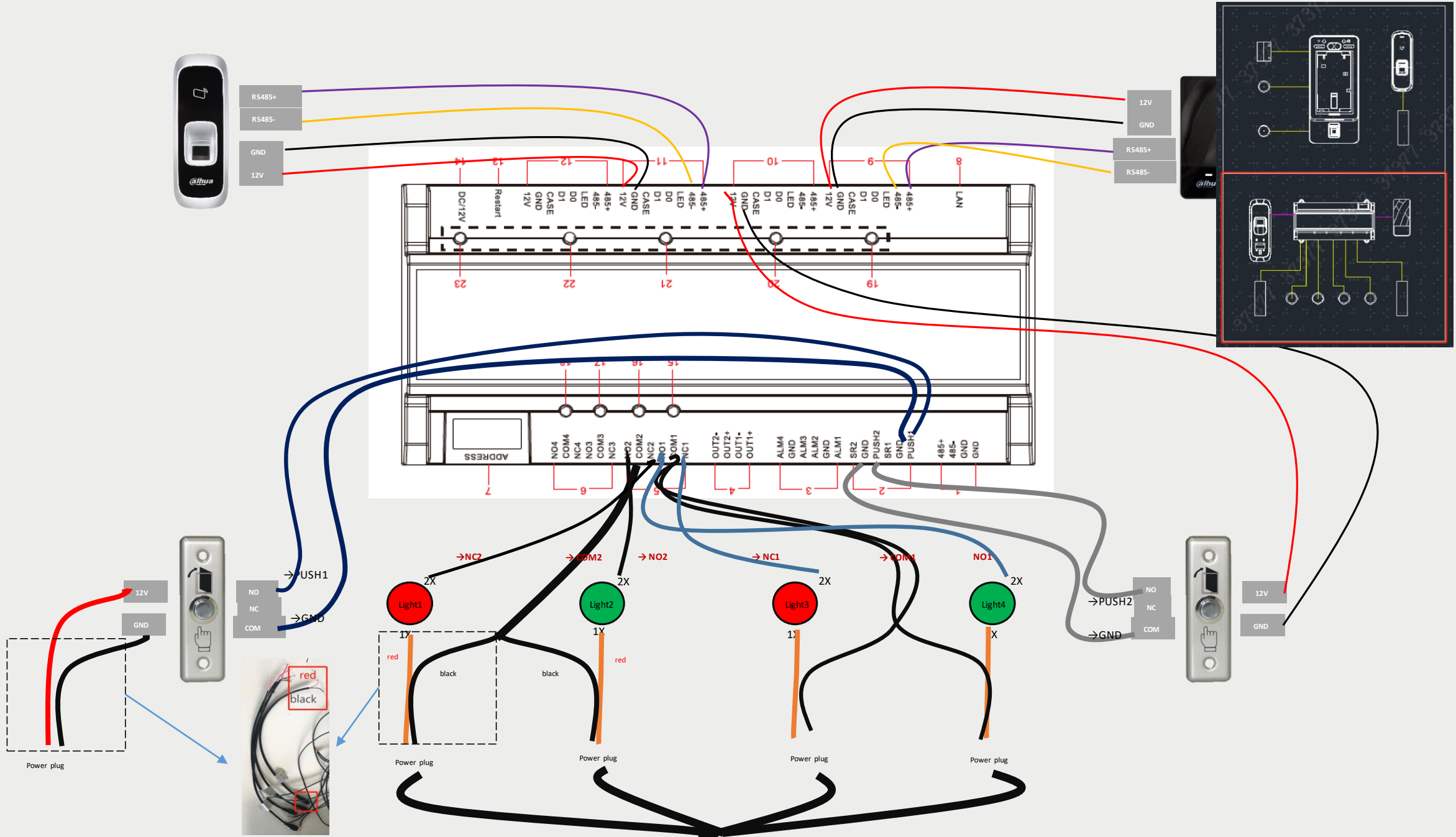

Accessories

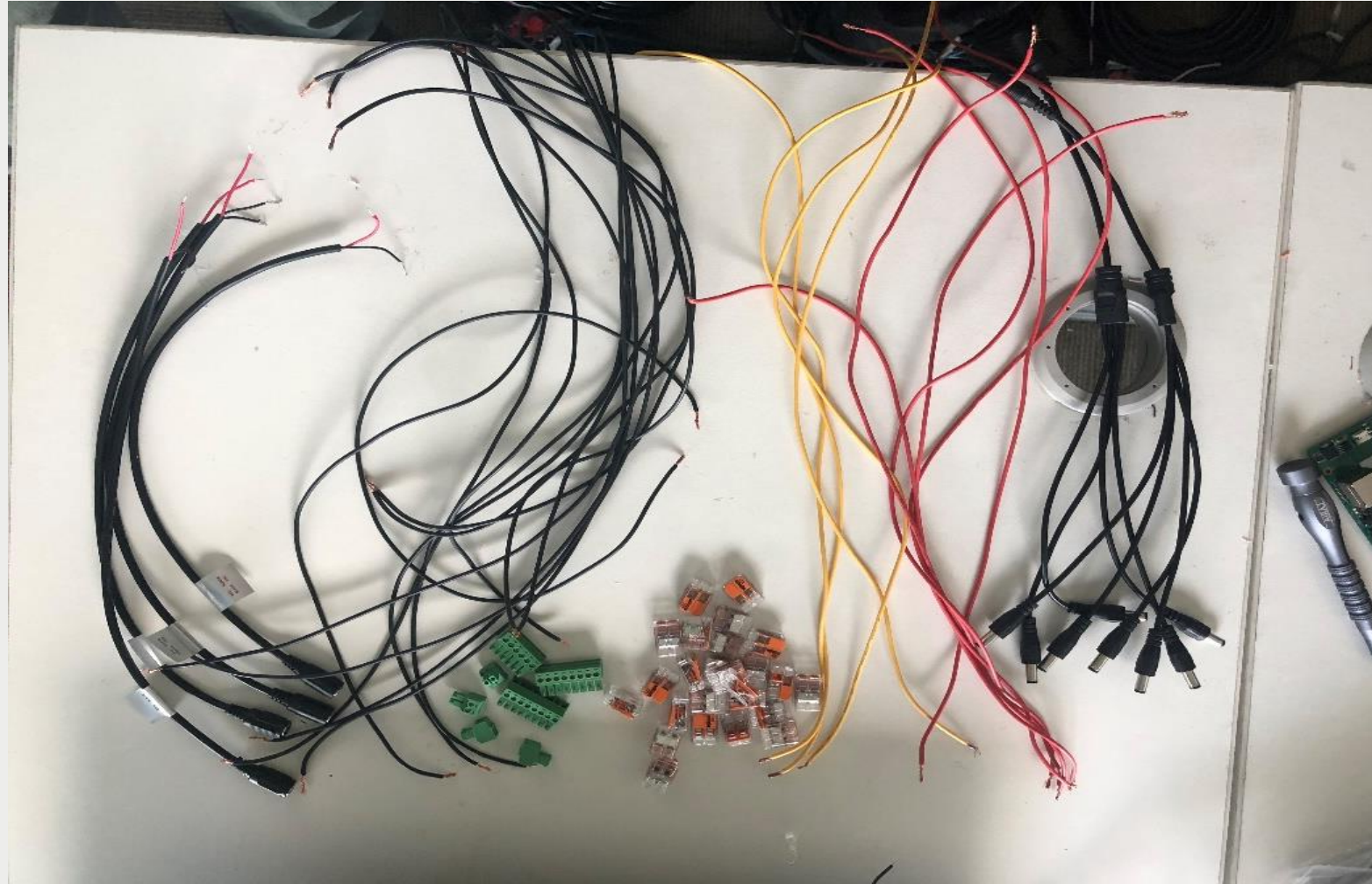

Wiring Notes

- **Switch button:**

- NO → PUSH1
- COM → GND
- (red) → 12V or Power (red)
- (black) → GND or Power (black)

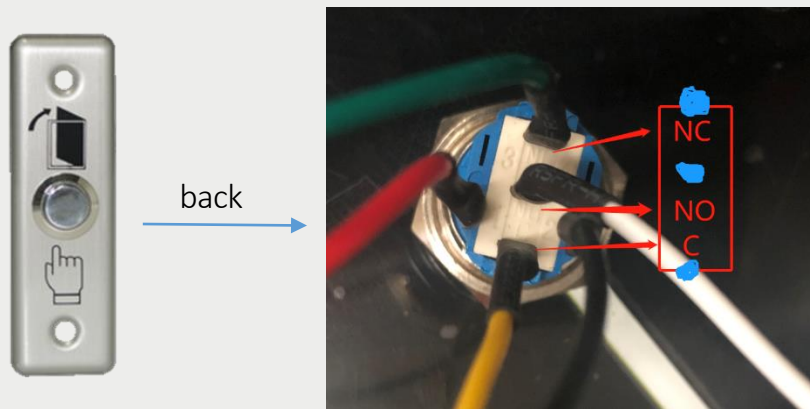

- **Reader:**

- 12V (red) → Power (red)
- GND (black) → Power (black)
- RS485+ (purple) → RS485+
- RS485- (yellow) → RS485-



Wiring Notes

- **Indicator light:**
- **Port “1+” means “+”、 Port “2+” means “-”**
 - Light1 (red) : **1+** → Power(red)
 - Light1 (red) : **2+** → NC2
 - Light2 (green) : **1+** → Power(red)
 - Light2 (green) : **2+** → NO2
 - Power(black)*2 → COM2